

51xxx

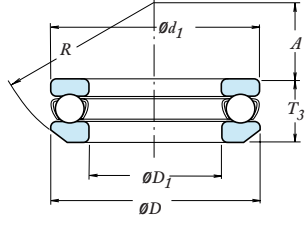

53xxx

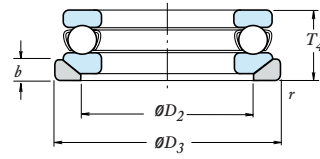

53xxxU

מידות [מ"מ]						מק"ט			עומסים				מהירות מירבית [סל"ד]		משקל
d	D	T	r min	d1	D1				[ניוטון] [N]		[ק"ג כח] [kgf]		גרזין	שטן	[ק"ג]
						Ca	Coa		Ca	Coa					
10	24	9	0.3	24	11	51100	-	-	10100	14000	1030	1420	6700	10000	0.019
	26	11	0.6	26	12	51200	53200	53200U	12800	17100	1300	1740	6000	9000	0.028
12	26	9	0.3	26	13	51101	-	-	10400	15400	1060	1570	6700	10000	0.021
	28	11	0.6	28	14	51201	53201	53201U	13300	19000	1350	1940	5600	8500	0.031
15	28	9	0.3	28	16	51102	-	-	10600	16800	1080	1710	6300	9500	0.023
	32	12	0.6	32	17	51202	53202	53202U	16700	24800	1710	2530	5000	7500	0.043
17	30	9	0.3	30	18	51103	-	-	11400	19500	1170	1990	6000	9000	0.025
	35	12	0.6	35	19	51203	53203	53203U	17300	27300	1760	2780	4800	7500	0.05
20	35	10	0.3	35	21	51104	-	-	15100	26600	1540	2710	5300	8000	0.037
	40	14	0.6	40	22	51204	53204	53204U	22500	37500	2290	3850	4300	6300	0.077
25	42	11	0.6	42	26	51105	-	-	19700	37000	2010	3800	4800	7100	0.056
	47	15	0.6	47	27	51205	53205	53205U	28000	50500	2860	5150	3800	5600	0.111
	52	18	1	52	27	51305	53305	53305U	36000	61500	3650	6250	3200	5000	0.169
	60	24	1	60	27	51405	53405	53405U	56000	89500	5700	9100	2600	4000	0.334
30	47	11	0.6	47	32	51106	-	-	20600	42000	2100	4300	4300	6700	0.064
	52	16	0.6	52	32	51206	53206	53206U	29500	58000	3000	5950	3400	5300	0.137
	60	21	1	60	32	51306	53306	53306U	43000	78500	4400	8000	2800	4300	0.267
	70	28	1	70	32	51406	53406	53406U	73000	126000	7450	12800	2200	3400	0.519
35	52	12	0.6	52	37	51107	-	-	22100	49500	2250	5050	4000	6000	0.081
	62	18	1	62	37	51207	53207	53207U	39500	78000	4050	7950	3000	4500	0.21
	68	24	1	68	37	51307	53307	53307U	56000	105000	5700	10700	2400	3800	0.386
	80	32	1.1	80	37	51407	53407	53407U	87500	155000	8950	15800	2000	3000	0.769
40	60	13	0.6	60	42	51108	-	-	27100	63000	2770	6400	3600	5300	0.12
	68	19	1	68	42	51208	53208	53208U	47500	98500	4850	10000	2800	4300	0.27
	78	26	1	78	42	51308	53308	53308U	70000	135000	7100	13700	2200	3400	0.536
	90	36	1.1	90	42	51408	53408	53408U	103000	188000	10500	19100	1700	2600	1.1
45	65	14	0.6	65	47	51109	-	-	28100	69000	2860	7050	3400	5000	0.143
	73	20	1	73	47	51209	53209	53209U	48000	105000	4900	10700	2600	4000	0.31
	85	28	1	85	47	51309	53309	53309U	80500	163000	8200	16700	2000	3000	0.672
	100	39	1.1	100	47	51409	53409	53409U	128000	246000	13000	25100	1600	2400	1.46
50	70	14	0.6	70	52	51110	-	-	29000	75500	2960	7700	3200	4800	0.153
	78	22	1	78	52	51210	53210	53210U	49000	111000	5000	11400	2400	3600	0.378
	95	31	1.1	95	52	51310	53310	53310U	97500	202000	9950	20600	1800	2800	0.931
	110	43	1.5	110	52	51410	53410	53410U	147000	288000	15000	29400	1400	2200	1.94
55	78	16	0.6	78	57	51111	-	-	35000	93000	3600	9500	2800	4300	0.227
	90	25	1	90	57	51211	53211	53211U	70000	159000	7150	16200	2200	3200	0.599
	105	35	1.1	105	57	51311	53311	53311U	115000	244000	11800	24900	1600	2400	1.31
	120	48	1.5	120	57	51411	53411	53411U	181000	350000	18500	35500	1300	1900	2.58
60	85	17	1	85	62	51112	-	-	41500	113000	4250	11500	2600	4000	0.281
	95	26	1	95	62	51212	53212	53212U	71500	169000	7300	17200	2000	3000	0.673
	110	35	1.1	110	62	51312	53312	53312U	119000	263000	12100	26800	1600	2400	1.4
	130	51	1.5	130	62	51412	53412	53412U	202000	395000	20600	40500	1200	1800	3.16

Bearings Tables; sponsored by NSK Ltd.

הגרזין המומלץ למיסבים הוא: לתנאים רגילים **GREASE-PS2**, לחדרים נקיים **GREASE-LGU**. הגרזין ניתן לרכישה בג'יג'י-ירום גטר.

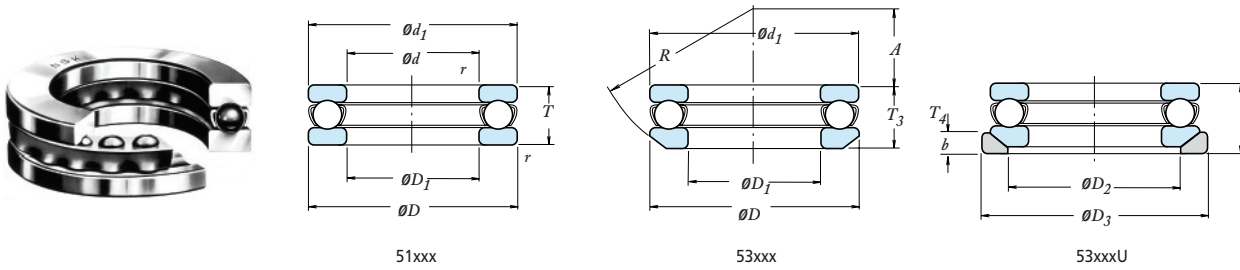

מידות [מ"מ]					מק"ט			עומסים				מהירות מירבית [סל"ד]		משקל	
d	D	T	r min	d1	D1				[ניוטון] [N]		[ק"ג כח] [kgf]		גרזיז	שטן	[ק"ג]
						Ca	Coa	Ca	Coa	Ca	Coa				
65	90	18	1	90	67	51113	-	-	42000	117000	4300	12000	2400	3800	0.324
	100	27	1	100	67	51213	53213	53213U	75500	189000	7700	19200	1900	2800	0.756
	115	36	1.1	115	67	51313	53313	53313U	123000	282000	12500	28700	1500	2400	1.54
	140	56	2	140	68	51413	53413	53413U	234000	495000	23800	50500	1100	1700	4.1
70	95	18	1	95	72	51114	-	-	43500	127000	4450	12900	2400	3600	0.346
	105	27	1	105	72	51214	53214	53214U	74000	189000	7550	19200	1900	2800	0.793
	125	40	1.1	125	72	51314	53314	53314U	137000	315000	14000	32000	1400	2000	2
	150	60	2	150	73	51414	53414	53414U	252000	555000	25700	56500	1000	1500	5.05
75	100	19	1	100	77	51115	-	-	43500	131000	4450	13400	2200	3400	0.389
	110	27	1	110	77	51215	53215	53215U	78000	209000	7950	21300	1800	2800	0.845
	135	44	1.5	135	77	51315	53315	53315U	159000	365000	16200	37500	1300	1900	2.6
	160	65	2	160	78	51415	53415	53415U	254000	560000	25900	57000	950	1400	6.15
80	105	19	1	105	82	51116	-	-	45000	141000	4600	14400	2200	3400	0.417
	115	28	1	115	82	51216	53216	53216U	79000	218000	8050	22300	1800	2600	0.931
	140	44	1.5	140	82	51316	53316	53316U	164000	395000	16700	40000	1300	1900	2.74
	170	68	2.1	170	83	51416	53416	53416U	272000	620000	27800	63500	900	1300	7.21
85	110	19	1	110	87	51117	-	-	46500	150000	4700	15300	2200	3200	0.44
	125	31	1	125	88	51217	53217	53217U	96000	264000	9800	26900	1600	2400	1.22
	150	49	1.5	150	88	51317	53317	53317U	207000	490000	21100	50000	1100	1700	3.57
	180	72	2	177	88	51417X	53417X	53417XU	310000	755000	31500	77000	850	1300	8.51
90	120	22	1	120	92	51118	-	-	60000	190000	6150	19400	1900	3000	0.646
	135	35	1.1	135	93	51218	53218	53218U	114000	310000	11600	31500	1400	2200	1.69
	155	50	1.5	155	93	51318	53318	53318U	214000	525000	21900	53500	1100	1700	3.83
	190	77	2.1	187	93	51418X	53418X	53418XU	330000	825000	33500	84000	800	1200	10.2
100	135	25	1	135	102	51120	-	-	86000	268000	8750	27300	1700	2600	0.96
	150	38	1.1	150	103	51220	53220	53220U	135000	375000	13700	38500	1300	2000	2.25
	170	55	1.5	170	103	51320	53320	53320U	239000	595000	24300	61000	1000	1500	4.98
	210	85	3	205	103	51420X	53420X	53420XU	370000	985000	38000	100000	710	1100	14.8
110	145	25	1	145	112	51122	-	-	88000	288000	8950	29400	1700	2400	1.04
	160	38	1.1	160	113	51222	53222	53222U	136000	395000	13900	40000	1300	1900	2.42
	190	63	2	187	113	51322X	53322X	53322XU	282000	755000	28800	77000	900	1300	7.19
	230	95	3	225	113	51422X	53422X	53422XU	415000	1150000	42000	118000	630	950	20
120	155	25	1	155	122	51124	-	-	90000	310000	9150	31500	1600	2400	1.12
	170	39	1.1	170	123	51224	53224	53224U	141000	430000	14400	44000	1200	1800	2.7
	210	70	2.1	205	123	51324X	53324X	53324XU	330000	930000	33500	95000	800	1200	9.7
	250	102	4	245	123	51424X	53424X	53424XU	480000	1400000	49000	142000	600	900	26.2
130	170	30	1	170	132	51126	-	-	105000	350000	10700	36000	1400	2000	1.68
	190	45	1.5	187	133	51226X	53226X	53226XU	183000	550000	18700	56000	1100	1600	3.95
	225	75	2.1	220	134	51326X	53326X	53326XU	350000	1030000	35500	105000	750	1100	12.1
	270	110	4	265	134	51426X	53426X	53426XU	525000	1590000	53500	162000	530	800	32.3
140	180	31	1	178	142	51128X	-	-	107000	375000	11000	38500	1300	2000	1.83
	200	46	1.5	197	143	51228X	53228X	53228XU	186000	575000	18900	59000	1000	1500	4.3
	240	80	2.1	235	144	51328X	53328X	53328XU	370000	1130000	37500	115000	670	1000	14.2
	280	112	4	275	144	51428X	53428X	53428XU	550000	1750000	56500	178000	530	800	34.7

Bearings Tables; sponsored by NSK Ltd.

הגרזיז המומלץ למיסבים הוא: לתנאים רגילים **GREASE-PS2**, לחדרים נקיים **GREASE-LGU**. הגרזיז ניתן לרכישה בג'י-ירום גטר.